

INSTALLATION INSTRUCTIONS - UNIVERSAL BRACKET

The Universal Bracket can be used to secure the Sign Light to post diameters of 144mm or above.

- Tighten Tamtorque banding around the post and Universal Bracket at the top and base. The banding will fit into the grooves in the bracket as shown in Fig. 9.

For double sided installations two brackets can be secured using the same Tamtorque banding.

- Now follow the instructions for 'Mid Post' installation on Page 3 - Fig. 5 - 8.

Note: Ensure lower edge of bracket is 100mm above the top of the sign.

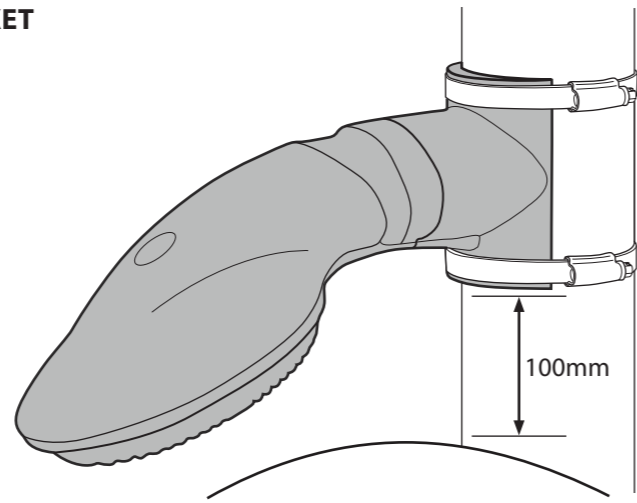

FIG. 9

INSTALLATION INSTRUCTIONS - WALL MOUNTING KIT

- Using the wall bracket as a drilling jig mark through the 4 outer holes using chalk the drill 100mm deep holes at the points using a Ø6mm masonry drill bit. (Ensure the lower edge of this bracket is 100mm above the traffic sign).

- Fix the bracket to the wall using the 4 washers and anchor bolts as shown.

- Slot the 2 cover plates into grooves in the universal bracket and secure this bracket to the wall bracket using the 2off washers and 3off screws as shown.

- Thread the cable through one of the two holes in the universal bracket and secure sign light to universal bracket by inserting the screw and 2 washers into the hole in the top of the bracket as shown.

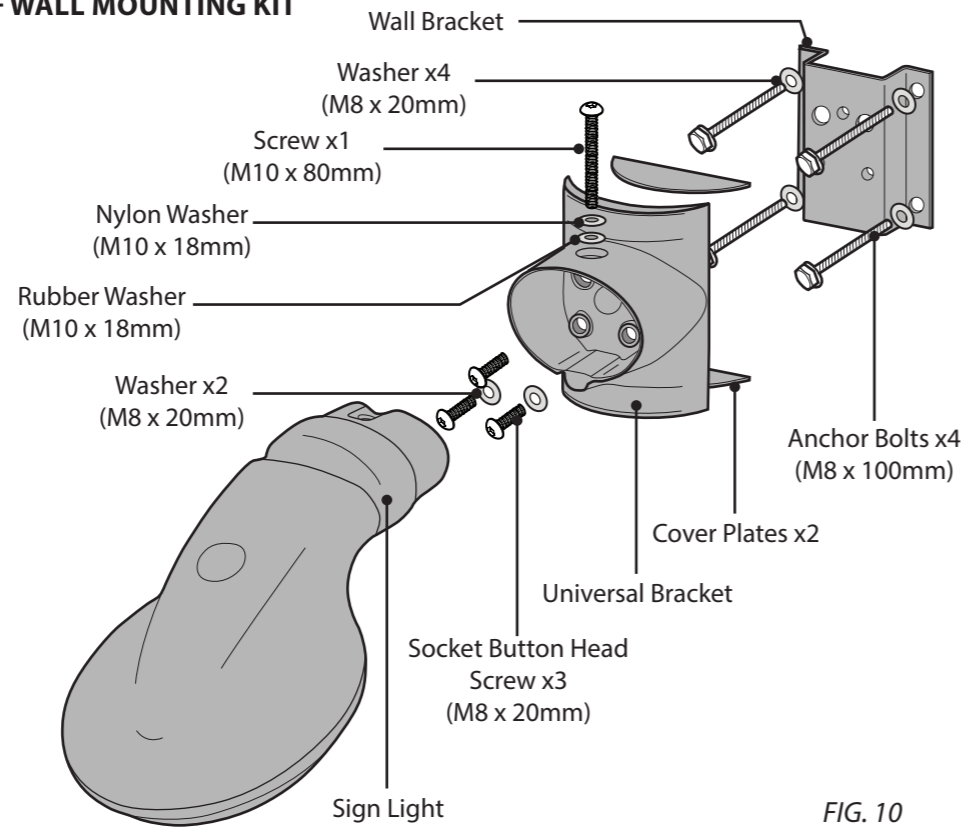

FIG. 10

CE Lumino City 750 and 1500 are CE Marked and have been designed to comply with the relevant Standards and Directives for its product classification. An EC Declaration of Conformity certificate and a copy of the CE Marking Technical File is available from the Glasdon UK Quality Assurance Department upon request.

IMPORTANT NOTE: PLEASE ENSURE THAT ALL RELEVANT PERSONNEL READ THE POINTS LISTED WITHIN THIS LEAFLET AND THAT A COPY IS GIVEN TO STAFF INVOLVED WITH THE INSTALLATION AND MAINTENANCE OF THIS PRODUCT.

SAFETY NOTE: PLEASE REFER TO THE 'MANUAL HANDLING OPERATIONS REGULATIONS 1992' DURING HANDLING.

Glasdon AND LUMINO CITY ARE TRADEMARKS OR REGISTERED TRADEMARKS OF GLASDON GROUP OR ITS SUBSIDIARIES IN THE U.K AND OTHER COUNTRIES

- A planned maintenance schedule or regular inspection is recommended, replacing components as necessary.
- Replacement components are available direct from GLASDON.
- GLASDON cannot be held responsible for claims arising from incorrect installation, unauthorised modifications or misuse of the product.

Issue 4 March 2020 Stock no. C000/0443 DWG no. 02B-080-66

© Copyright 03/2020

Glasdon UK Ltd reserve the right to alter specifications without prior notice.



Glasdon U.K Limited
 Preston New Road
 BLACKPOOL
 Lancashire FY4 4UL
 Tel: 01253 600410
 Fax: 01253 792558
 Email: Sales@glasdon-uk.co.uk
 Web: www.glasdon.co.uk



LUMINO CITY™ INSTALLATION INSTRUCTIONS



Ensure that personnel carrying out this conversion have the relevant qualifications/certificates and all work is carried out in accordance with BS7671:2008/I.E.E. Wiring Regulations 17th Edition (IET Amendment 3:2015). Ensure that all relevant personnel read the points listed within this leaflet and that a copy is given to staff involved with the installation and maintenance of this product. Glasdon recommends that a full Health and Safety analysis is carried out prior to installation.

KIT CONTENTS

- ITEM 1 - Sign Light Unit (750 or 1500) x1 (x2 for Double Sided Unit)
 - ITEM 2 - Bracket Cap x1
 - ITEM 3 - Screw m10 x 80mm x1
 - ITEM 4 - Nylon Washer M10 x 18mm x1
 - ITEM 5 - Rubber Washer M10 x 18mm x1
 - ITEM 6 - Bracket c/w grub screws (single or double sided) x1
 - ITEM 7 - Bracket Collar x2
- Allen Key 4mm x1
 Allen Key 6mm x1

EQUIPMENT REQUIRED

- Relevant Safety Equipment
- Tape Measure

SIGN COMPATIBILITY

Lumino City	750	1500
Sign size, h		
600mm	•	
750mm	•	
900mm		•
1200mm		•
1500mm		•

- Optional**
- Photocell
 - Remote Monitoring Device Assembly

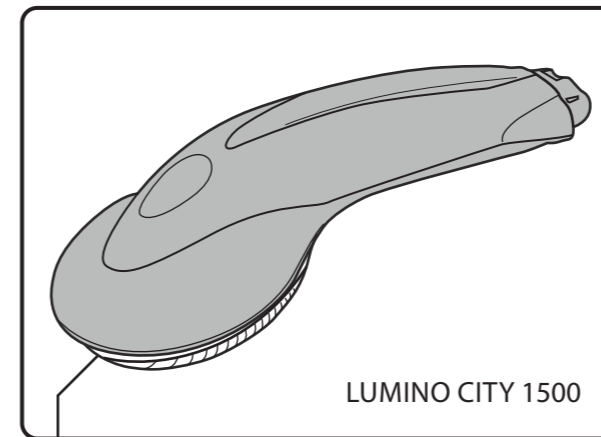

LUMINO CITY 1500

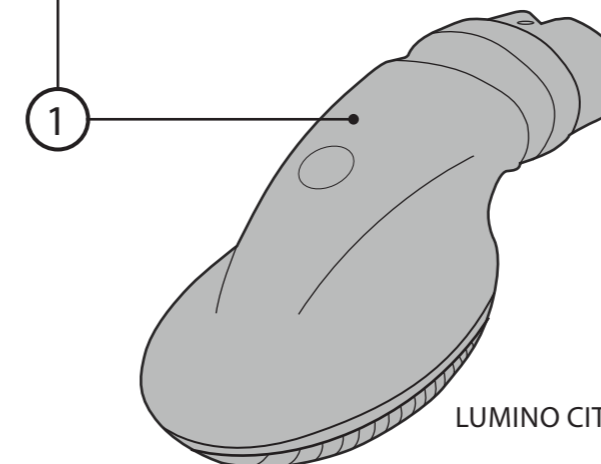

LUMINO CITY 750

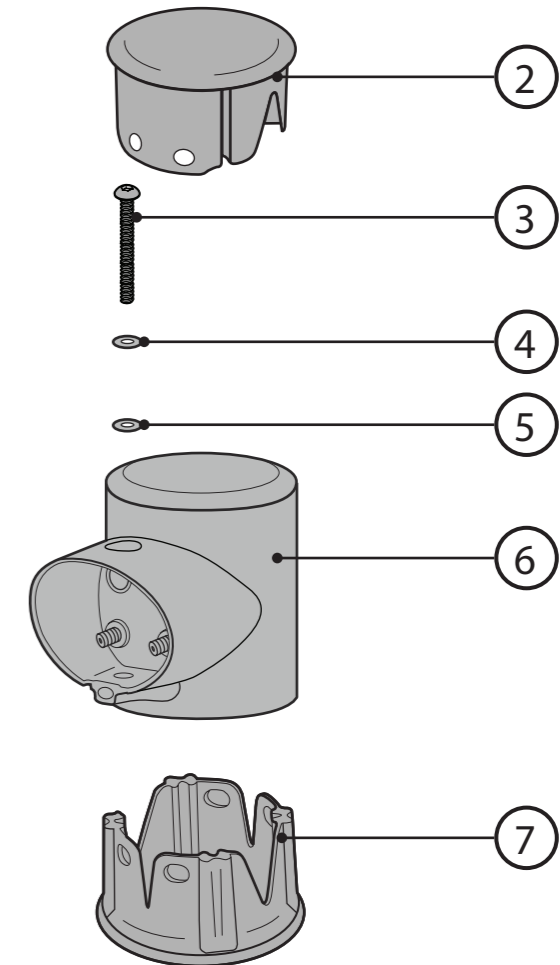
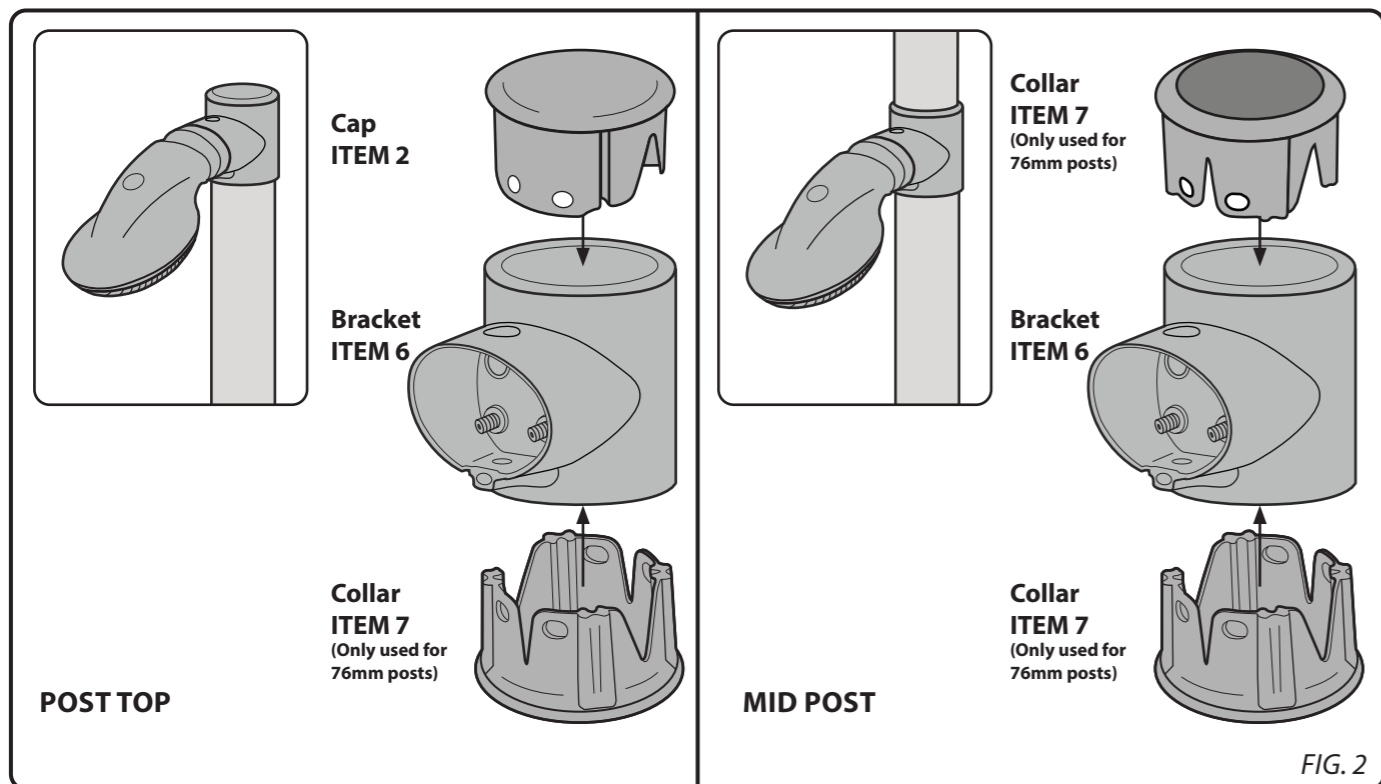

FIG. 1

Note: Diagrams are not to scale



PRODUCT ASSEMBLY - See Fig. 2

- POST TOP (76mm Posts)** - Insert the collar (ITEM 7) into the base of the bracket (ITEM 6) and the cap (ITEM 2) into the top of the bracket then discard the spare collar.
- POST TOP (89mm Posts)** - Insert the cap (ITEM 2) into the top of the bracket (ITEM 6) then discard the two spare collars (ITEM 7).
- MID POST (76mm Posts)** - Insert Collar (ITEM 7) into the base of the bracket (ITEM 6) and another collar into the top of the bracket. Discard the spare cap (ITEM 2).
- MID POST (89mm Posts)** - No collars (ITEM 7) or caps (ITEM 2) are required and they can all be discarded.

Note: Ensure the holes within Cap and Collar line up with the holes within the bracket.

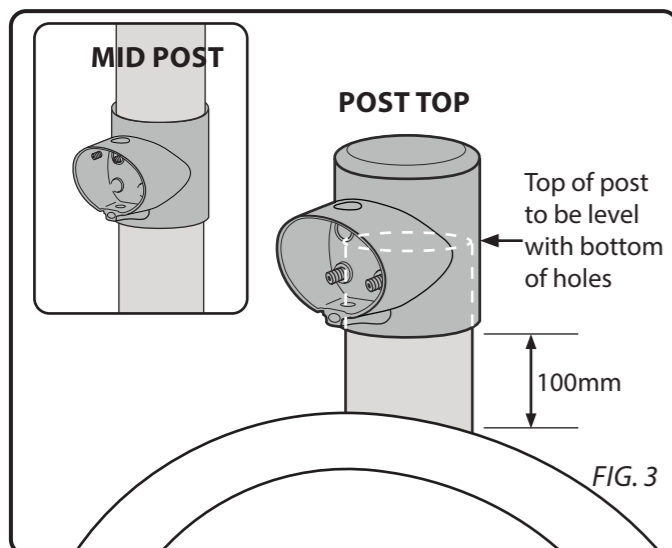

Slot the bracket (ITEM 6) onto the top of the post. Ensure that the distance between the top of the sign and the lower edge of the bracket is 100mm (see Fig. 3). Adjust the height of the sign if necessary to ensure the height of the sign complies with the guidance in the Traffic Signs Manual. For mid post installations slide the bracket down the post to the correct height (see Fig. 2).

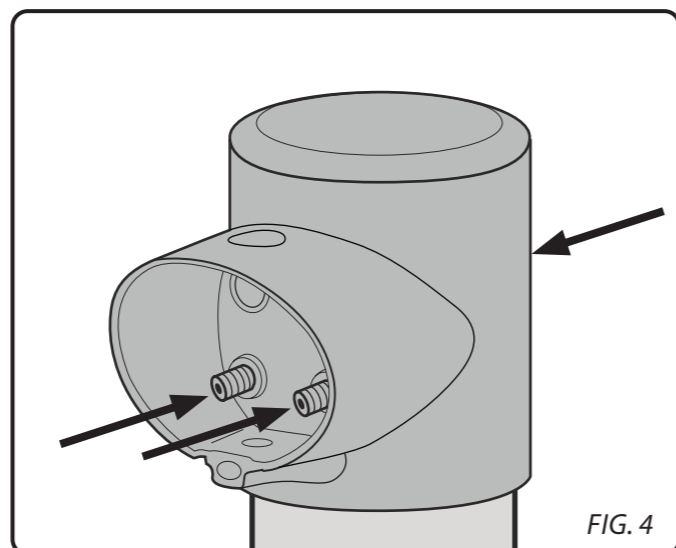

Tighten the grub screws using the 4mm allen key provided (there are 3 grub screws on the single sided bracket and 4 on the double sided bracket). See Fig. 4.

Note: Hand tighten all grub screws first to ensure bracket is level on the post, then tweak each in turn to level and then fully tighten to secure.

INSTALLATION INSTRUCTIONS

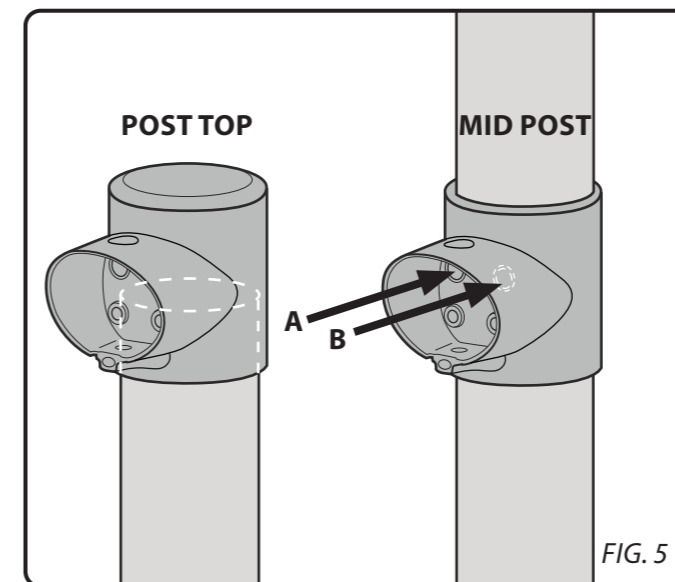

For 'Post Top' installations the bracket sits proud of the top of the post allowing the cable to be passed through the aperture in the bracket.

For 'Mid Post' installations the post must be drilled to provide an aperture for the cable. Using the bracket as a drilling jig and a 10mm drill bit - drill a hole in the post through aperture A (for non standard installations when the cable must be looped back out again, drill both A and B). See Fig 5.

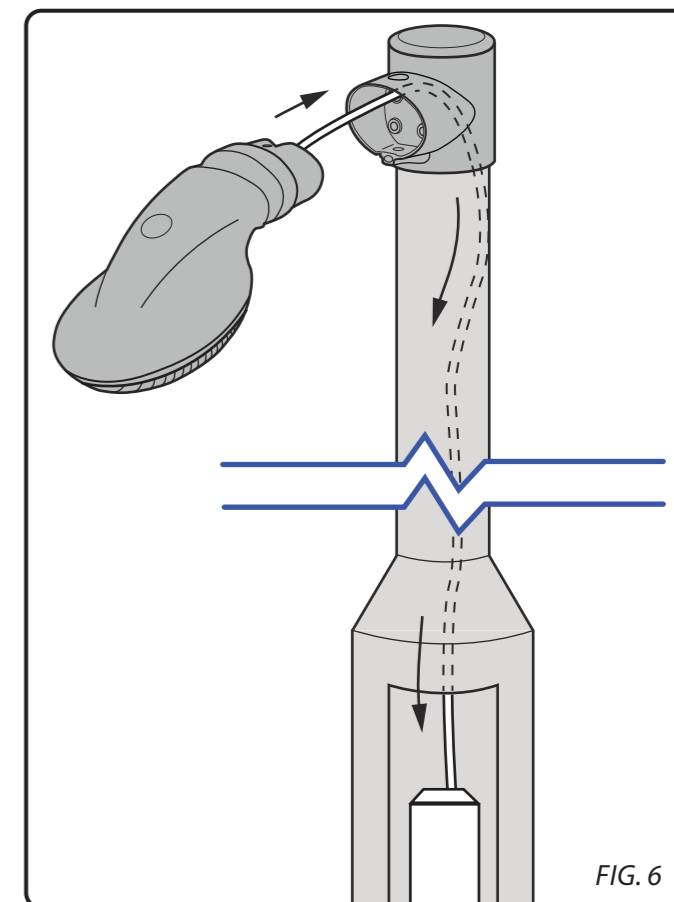

Thread the cable on the sign light through the aperture and down the post and insert sign light into the bracket. See Fig. 6.

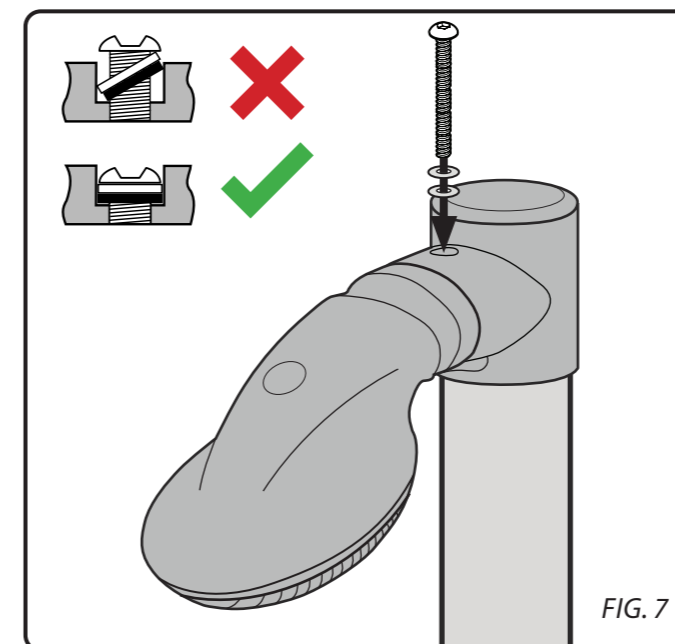

Secure the sign light to the bracket by inserting the screw (ITEM 3) and the two washers (ITEM 4 & 5) into the bracket as shown in Fig. 7. Tighten using the 6mm allen key provided.

Note: Make sure the washers are flat against the bracket.

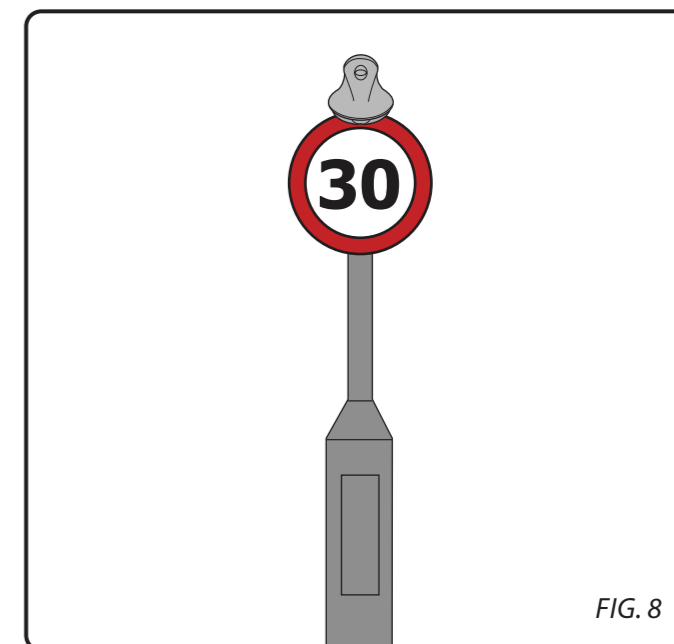

Wire the cable into the cut out and finally reconnect the power and secure access door.

Note: For the Lumino City 24V unit ensure a 24V ac transformer is used.