



RECYCLED MATERIAL PICNIC TABLE

FLAT PACK ASSEMBLY INSTRUCTIONS

IMPORTANT NOTE: ENSURE THAT ALL RELEVANT PERSONNEL READ THESE INSTRUCTIONS PRIOR TO USE

Please also refer to the 'Manual Handling Operations Regulations 1992' during the handling of the product and materials used for installation. Glasdon recommends that a full Health and Safety analysis is carried out prior to installation.

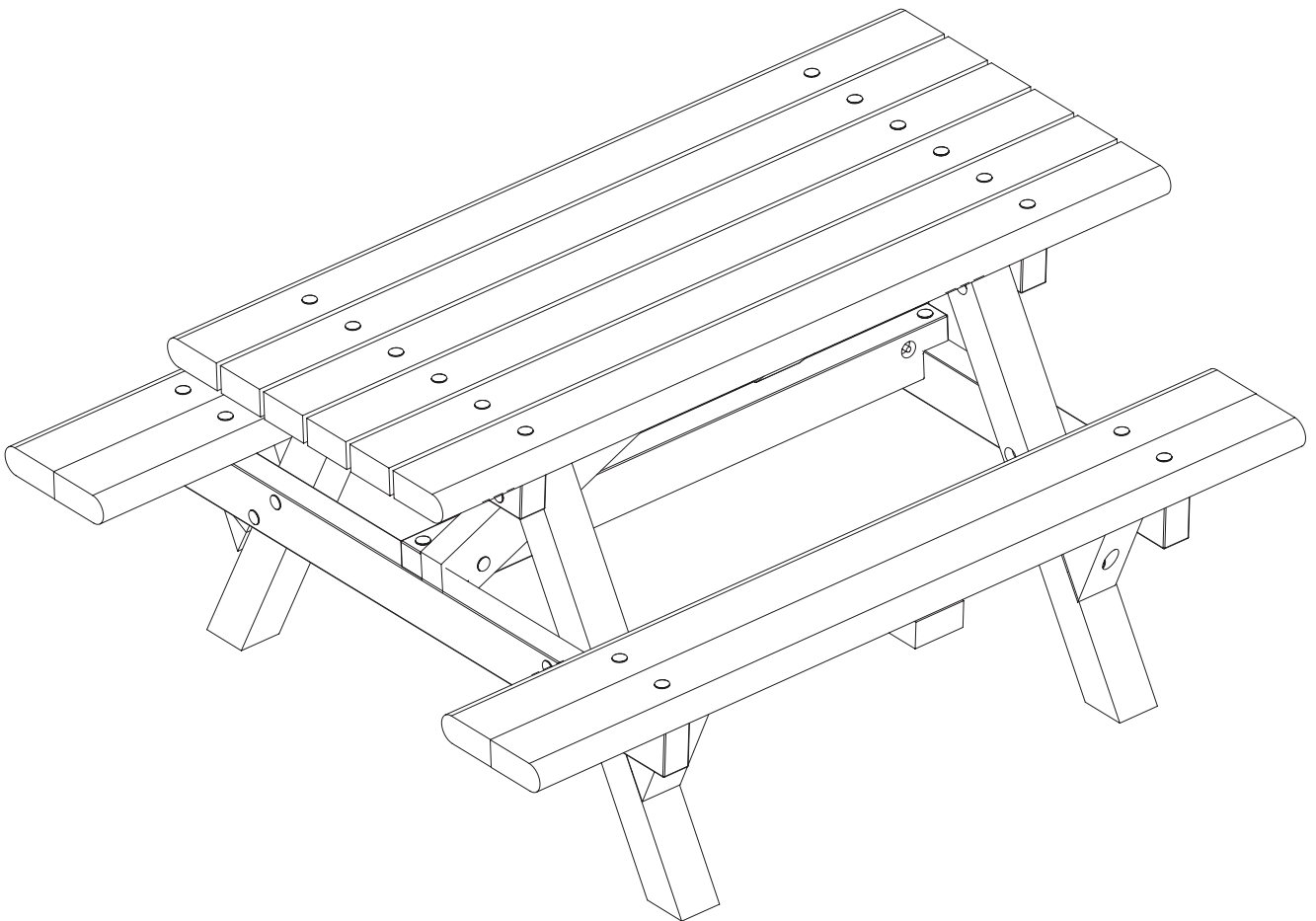

KIT CONTENTS:

- ITEM 1 - M10 x 140mm Carriage Bolt x 10
- ITEM 2 - Central Support Beam x 1
- ITEM 3 - Table Top Assembly x 1
- ITEM 4 - Angled Support Beam x 2
- ITEM 5 - M10 x 150mm Carriage Bolt x 2
- ITEM 6 - M10 Washer x 38
- ITEM 7 - M10 Nyloc Nut x 38
- ITEM 8 - M10 x 100mm Carriage Bolt x 2
- ITEM 9 - Support Cross Bar x 2
- ITEM 10 - Seat Leg x 4
- ITEM 11 - M10 x 120mm Carriage Bolt x 24
- ITEM 12 - Seat Pan Assembly x 2
- ITEM 13 - Seat Leg Support x 4

EQUIPMENT REQUIRED:

- 17mm Socket x 1
- Socket Driver x 1
- Socket Extension x 1
- Lump Hammer / Nylon Faced Hammer x 1

Assembly requires a minimum of 2 x people

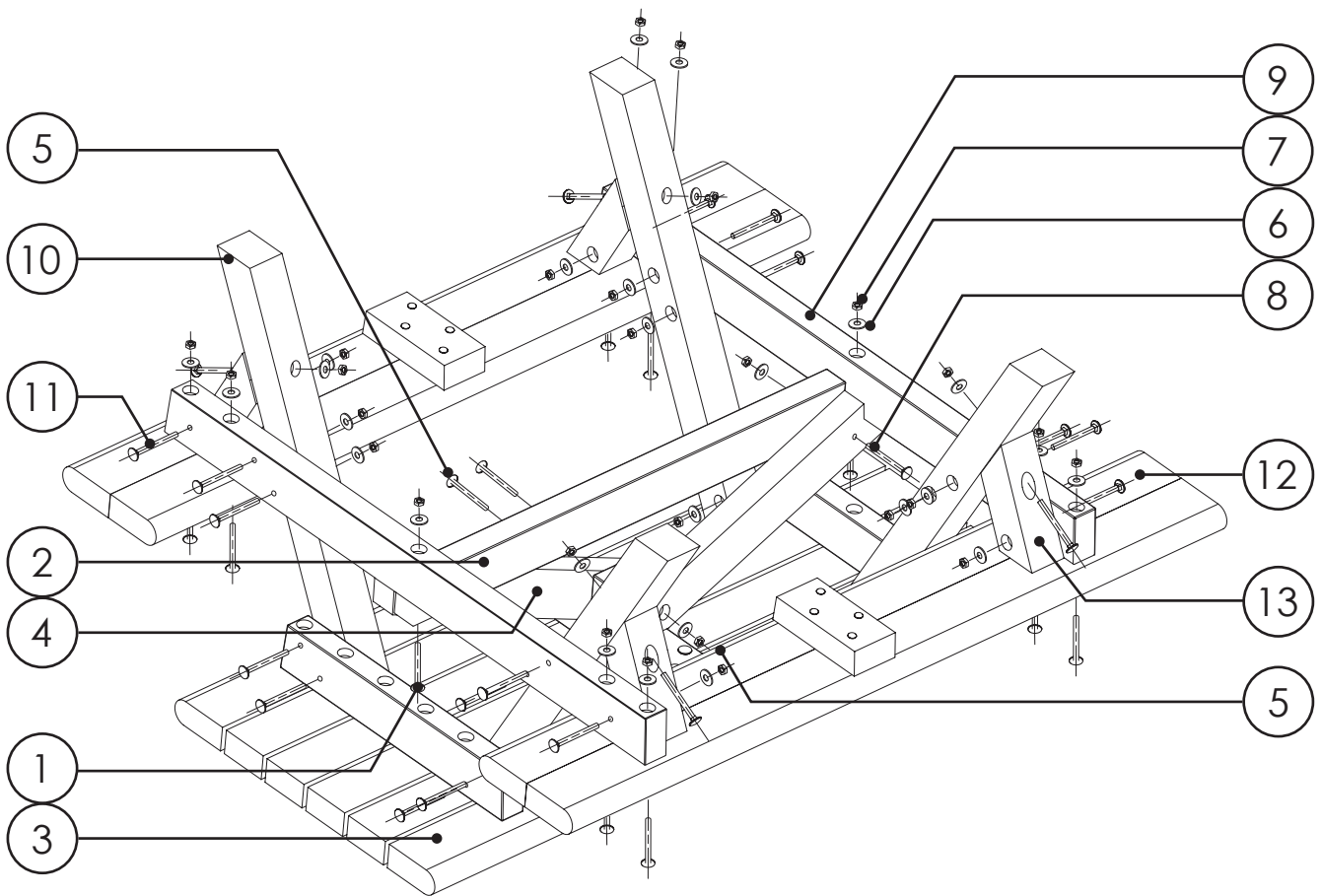

IMPORTANT NOTE:

Fixings should be driven in through the small hole in each frame component. The rear hole features a counterbore to accommodate a washer and nut to secure each fixing in place.

Take care to ensure each part is oriented correctly at each stage as per each assembly drawing.

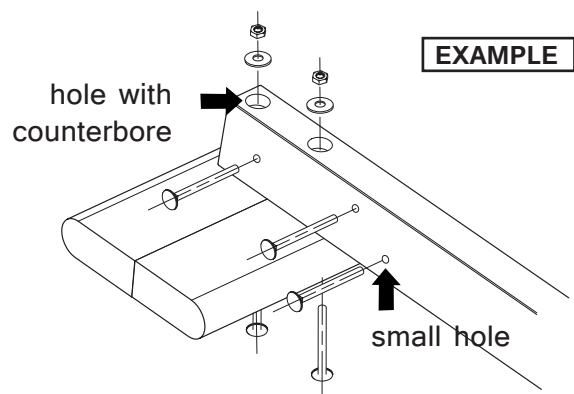
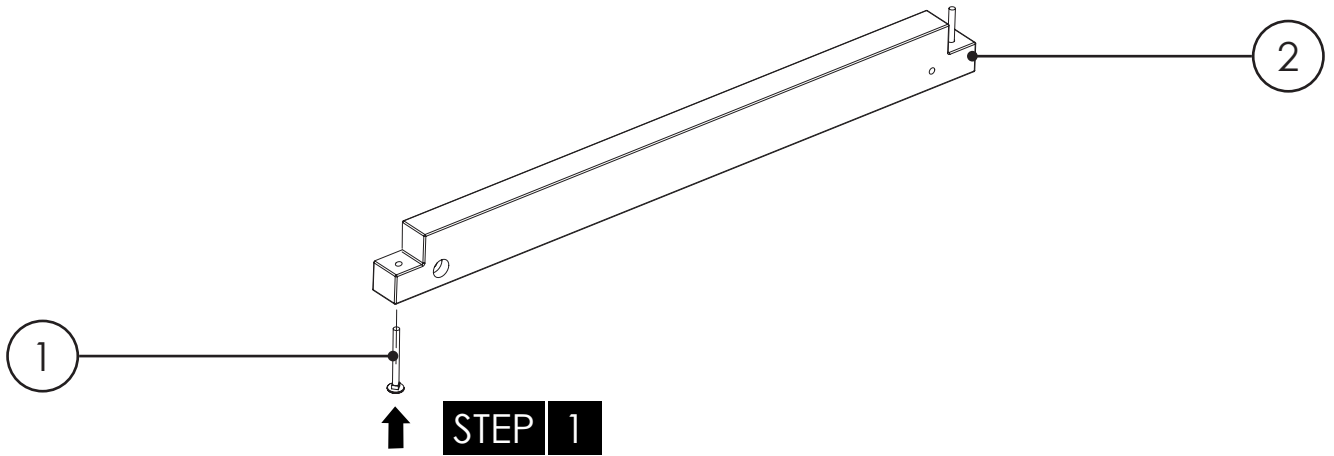

DIAGRAM NOT TO SCALE

ASSEMBLY INSTRUCTIONS



STEP 1

Fit Item 1 through the holes in Item 2 as shown. **Hammer the fixing firmly into place so that the square neck of the fixing bites into the Enviropol®.** You will need to do this for each fixing during the assembly.

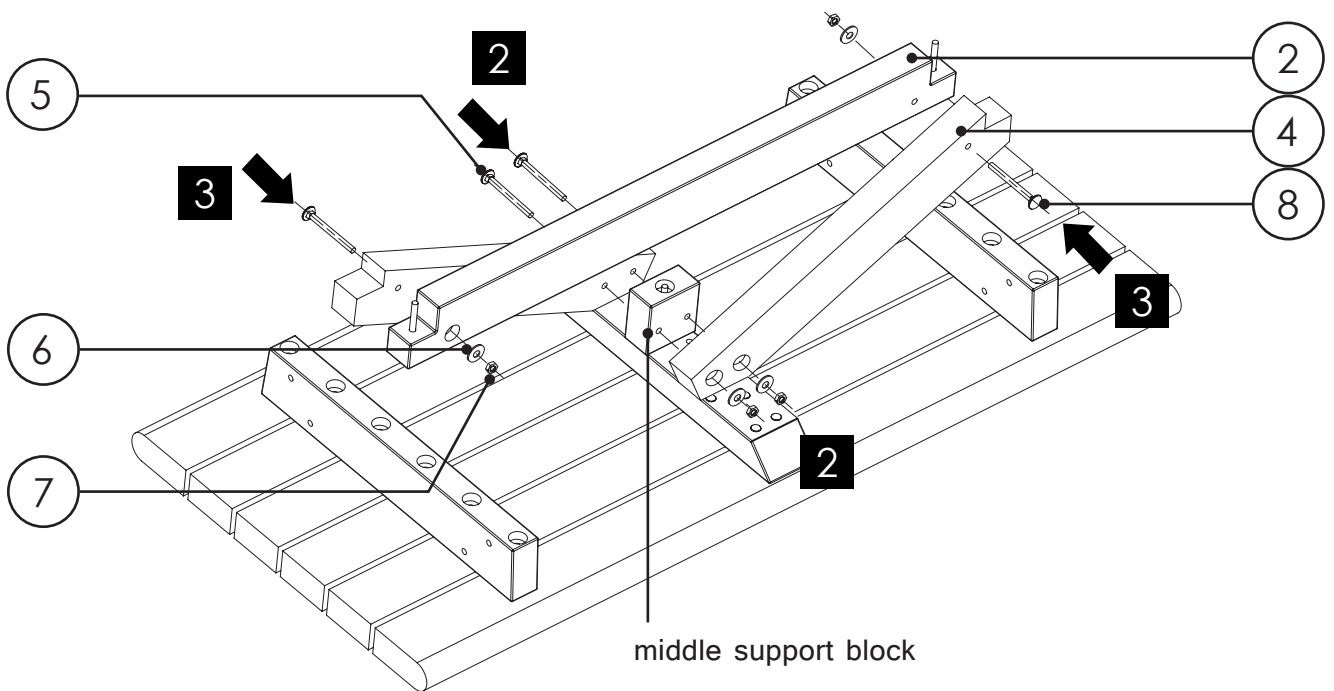

STEP 2

Set Item 3 down on the floor upside down. Rest Item 2 on top of the middle support block (attached to Item 3 assembly). Hammer 1 x Item 5 through one of the two parallel holes in one of the Item 4's. Hammer the fixing through the corresponding hole in the middle support block (see diagram) and finally through the corresponding fixing hole of the second Item 4. Place Item 6 and thread Item 7 onto the exposed fixing thread. Tighten the nut by hand. Repeat this STEP for the second fixing.

STEP 3

Hammer Item 8 through the single fixing hole in Item 4 and through the corresponding fixing hole in Item 2. You will need to lift the end of the Support Beam to align the holes in the two parts before pushing the fixing through. Place Item 6 and thread Item 7 onto the fixing thread. Tighten the nut by hand. Repeat this STEP for the second fixing. Tighten all 4 x fixings with the socket driver.

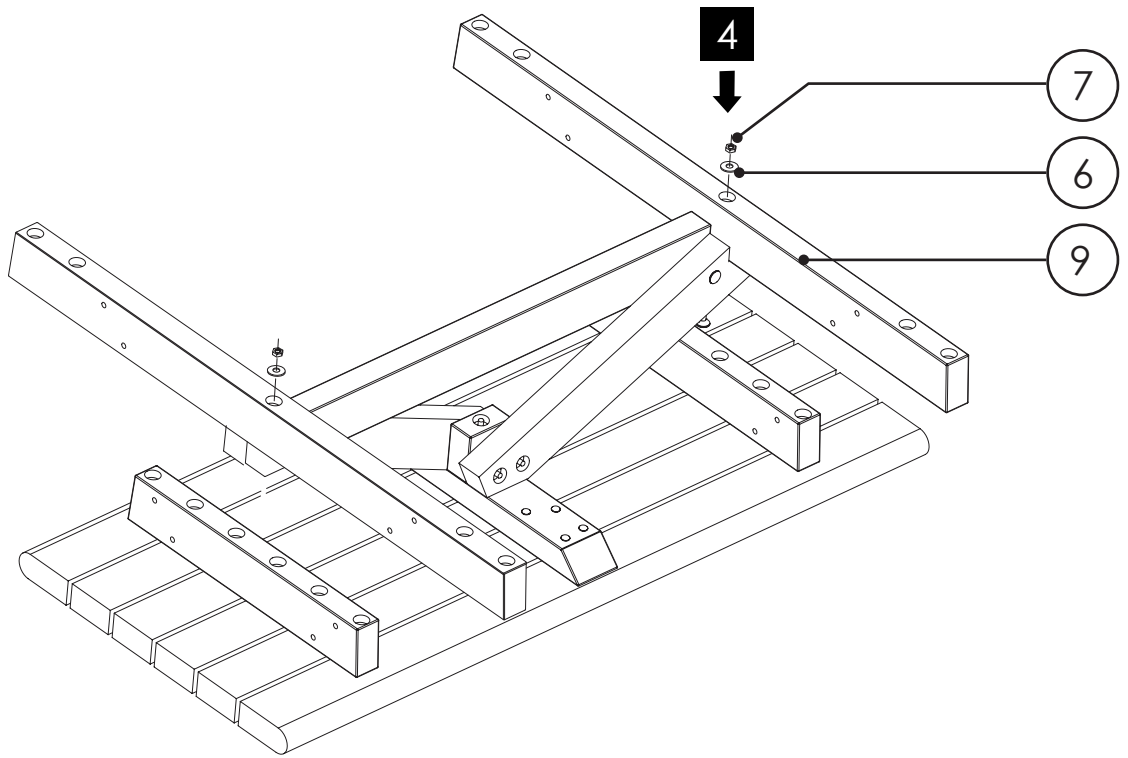

STEP 4

Place Item 9 onto the assembled support frame as shown. Slot the cross bar onto the exposed fixings protruding from Item 2 (fitted during STEP 1). Use the hammer if necessary. Place Item 6 and thread Item 7 onto the fixing thread. Tighten the nut by hand. Repeat for the second fixing. Tighten both fixings with the socket driver.

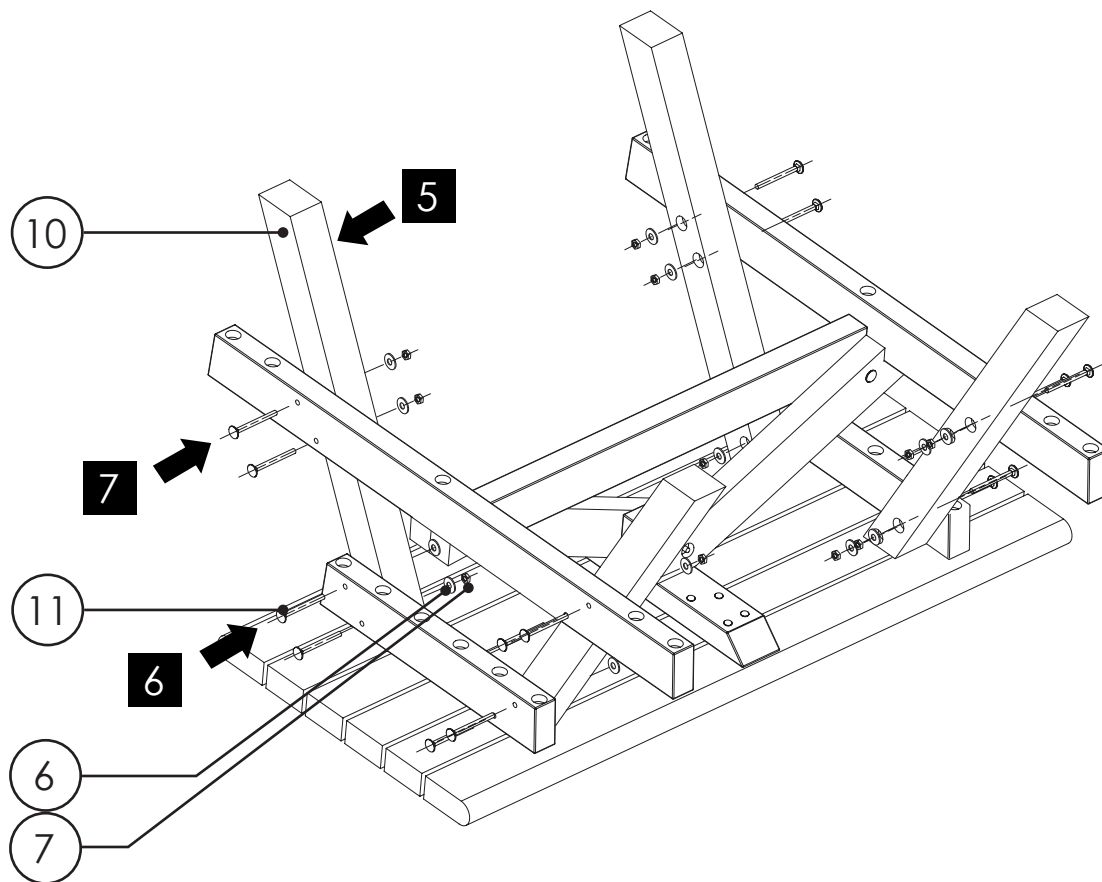

STEP 5

Place Item 10 against the inside of the assembled Support Frame as shown.

STEP 6

Hammer 2 x Item 11 into the 2 fixing holes in the assembled Support Frame (near to the Table Top) and through the corresponding fixing holes in the Legs. Place Item 6 and thread Item 7 onto the threads of the fixings. Tighten the nuts by hand. Repeat this STEP again for the 3 x remaining Legs.

STEP 7

Hammer 2 x Item 11 into the 2 x fixing holes in the Support Cross Bar (Item 9) and through the corresponding fixing holes in the Legs. Place Item 6 and thread Item 7 onto the threads of the fixings. Tighten the nuts by hand. Repeat this STEP again on the 3 x remaining Legs. Tighten each nut in turn using the socket driver.

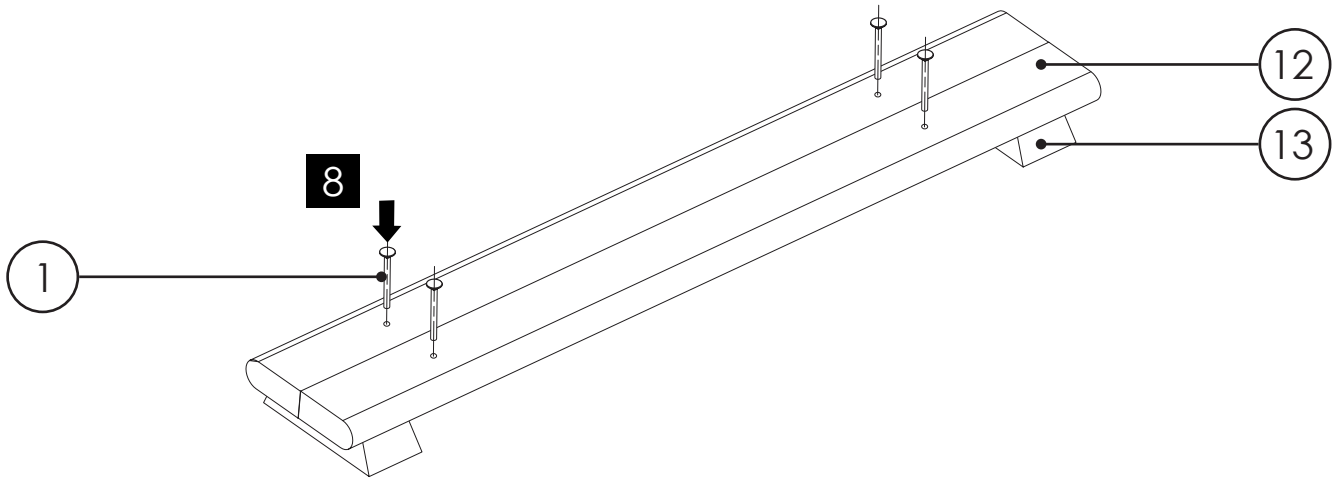

STEP 8

Hammer 4 x Item 1 into the 4 x fixing holes in both Item 12's. You may find it helpful to temporarily rest the Seat Pan on to 2 x Item 13's to raise the assembly off the ground sufficiently to allow the bolts to be hammered through.

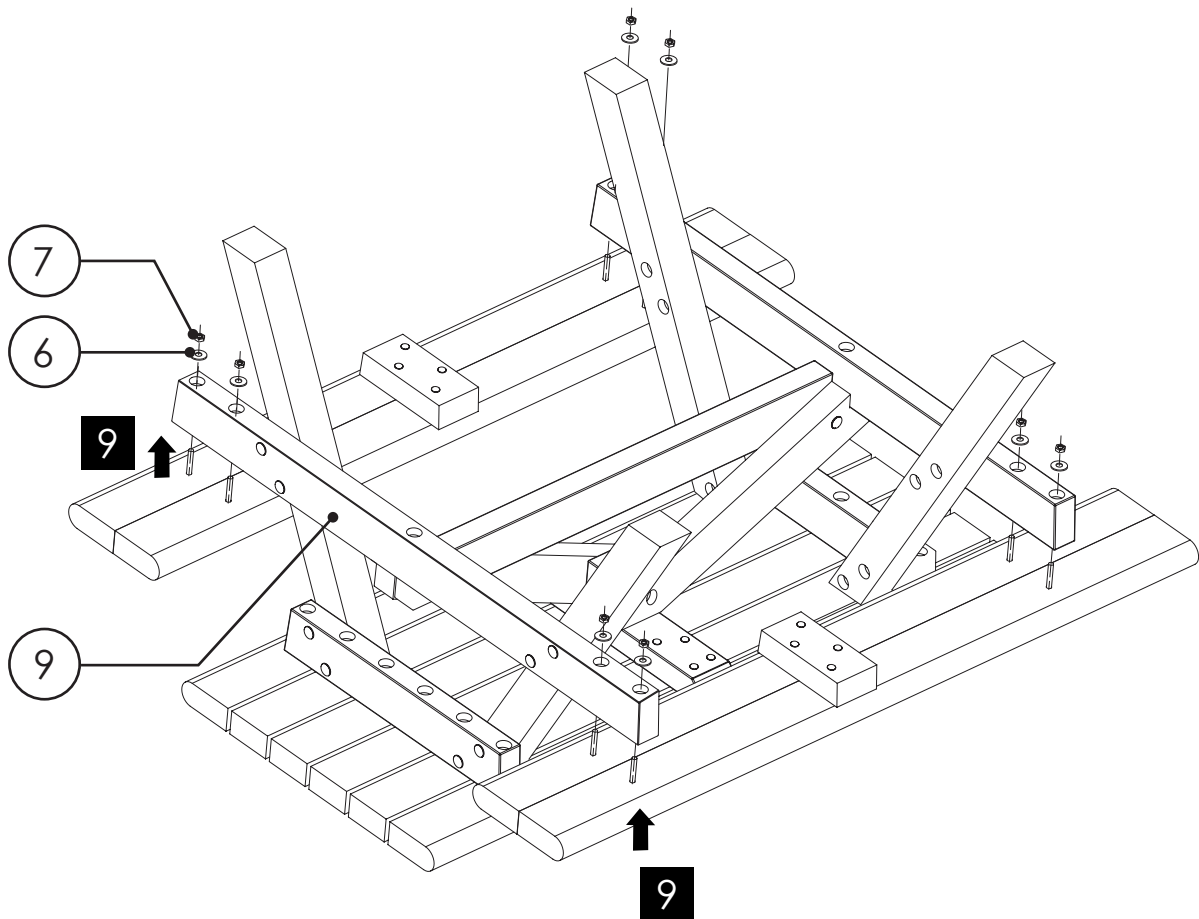

STEP 9

Raise the assembled Seat Pan up to the fixing holes in Item 9 (part of the assembled Support Frame). Use the hammer to tap the fixings through Item 9. Place Item 6's and thread Item 7's onto the fixing threads. Tighten the nuts by hand. Repeat the STEP to fix the opposing end of the Seat Pan to the Support Frame. Repeat the STEP again to affix the second Seat Pan to the opposing side of the Support Frame. Tighten all 8 x fixings with the socket driver.

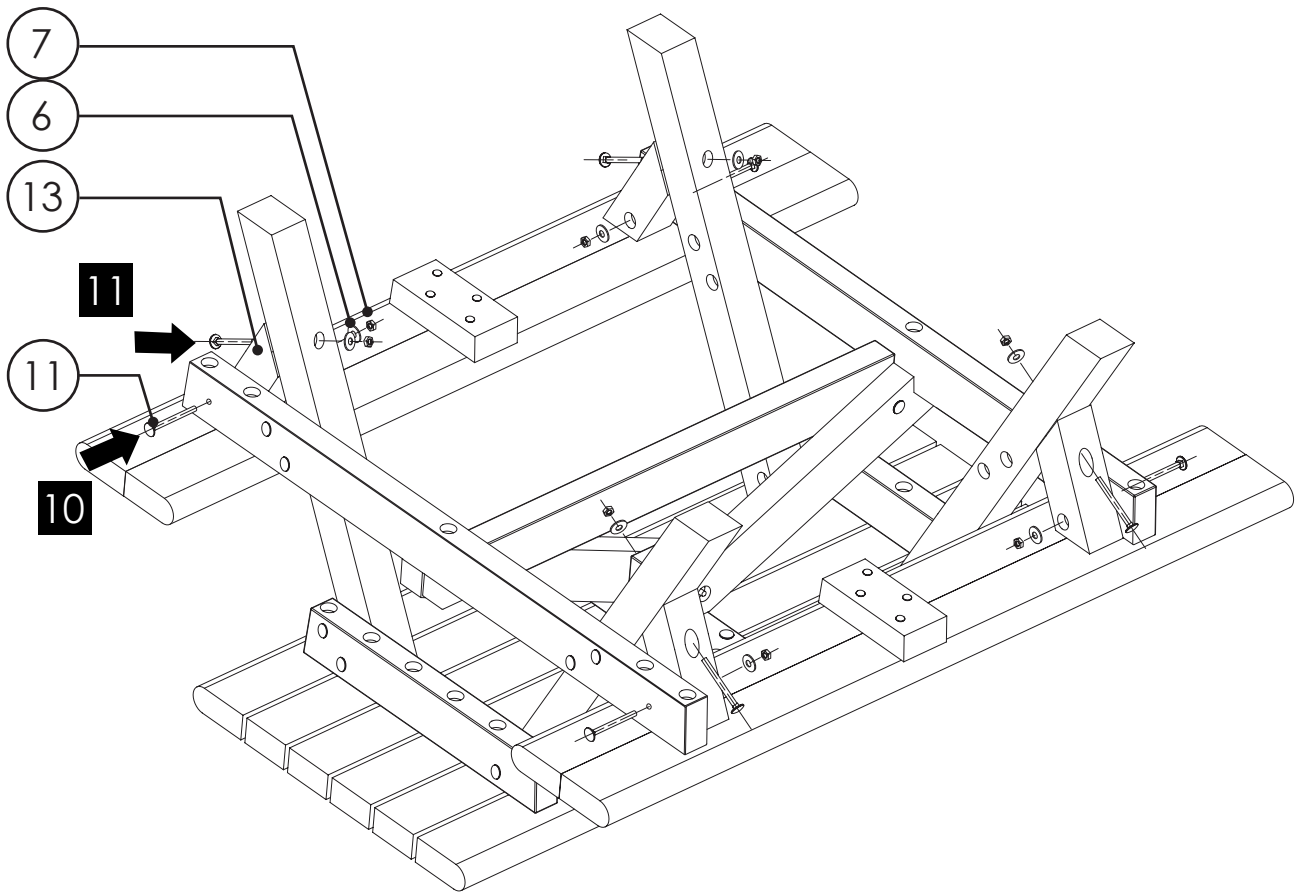

STEP 10

Place 4 x Item 13 under the Seat Legs as shown. Fix the Leg Supports in place by hammering Item 11 through the Support Cross Bar and through the Leg Supports. Place Item 6 and thread Item 7 onto the exposed fixing thread. Tighten the nut by hand. Repeat for the remaining 3 x Leg Supports.

STEP 11

Hammer Item 11's through the Leg Support fixing hole and through the Seat Leg. Place Item 6 and thread Item 7 onto the exposed fixing thread. Tighten the nut by hand. Repeat for the remaining 3 x Leg Supports.

Tighten the nuts using the socket driver complete with extension.

STEP 12

Turn the Picnic Table back over ready for siting and installation.

ASSEMBLY COMPLETE

IMPORTANT NOTE: PLEASE ENSURE THAT ALL RELEVANT PERSONNEL READ THE POINTS LISTED WITHIN THIS LEAFLET AND THAT A COPY IS GIVEN TO STAFF INVOLVED WITH THE INSTALLATION AND MAINTENANCE OF THIS PRODUCT.

SAFETY NOTE: PLEASE REFER TO 'THE MANUAL HANDLING OPERATIONS REGULATIONS 1992' DURING HANDLING.



Glasdon

AND ENVIROPOL ARE TRADEMARKS OR REGISTERED TRADEMARKS OF GLASDON GROUP OR ITS SUBSIDIARIES IN THE U.K. AND OTHER COUNTRIES

- A planned maintenance schedule or regular inspection is recommended, replacing components as necessary.
- Replacement components are available direct from GLASDON.
- GLASDON cannot be held responsible for claims arising from incorrect installation, unauthorised modifications or misuse of the product.

Stock No. C000/0506 - DWG No. 09B-022-49 Issue 1 - August 2017

© Copyright AUG 2017

Glasdon UK Ltd reserve the right to alter specifications without prior notice.



Glasdon

Glasdon U.K. Limited

Preston New Road
BLACKPOOL

Lancashire FY4 4UL

Tel : 01253 600410

Fax : 01253 792558

e-mail: sales@glasdon-uk.co.uk

web: www.glasdon.com