

VISAGE™ SCREEN SYSTEM - THREE SIDED (FLAT PACK)

ASSEMBLY & FIXING INSTRUCTION LEAFLET

NOTE: Ensure that all relevant personnel read the points listed below and that a copy is passed on to staff involved with the installation. Please also refer to the 'Manual Handling Operations Regulations 1992' during the handling of the product and materials used for installation. The total weight of this product is 53kg (770L) and 65kg (1280L).

TOOLS REQUIRED:

13mm Spanner	x1	17mm Spanner	x2
Hand Drill with Pozi Drill Bit	x1	6mm Allen Key	x1
10mm x 150mm Masonry Drill Bit	x1		
Rubber Mallet	x1		
Hammer	x1		

KIT CONTENTS:

		770L	1280L
ITEM A	Side Panel	x1	x1
ITEM B	Front Panel	x1	x1
ITEM C	Side Panel	x1	x1
ITEM D	5mm x 20mm Chipboard Screw	x29	x33
ITEM E	M10 x 120mm Ground Fixing Bolt	x6	x6
ITEM F	Support Leg	x2	x2
ITEM G	Side Skirting (optional)	x2	x2
ITEM H	Front Skirting (optional)	x1	x1
ITEM I	Repair Washer M5 x 25mm S/S (optional)	x16	x20

NOTE: Some fixings apply to the optional skirting so there may be less fixings than stated.

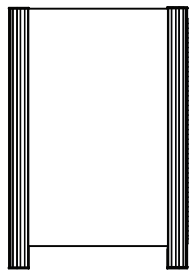
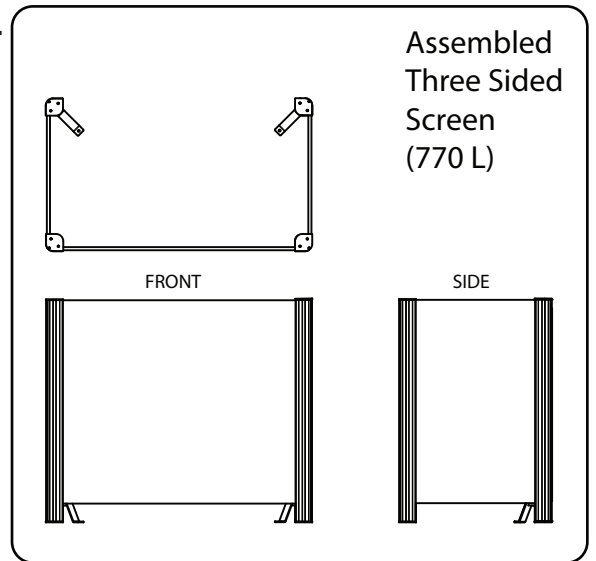

A

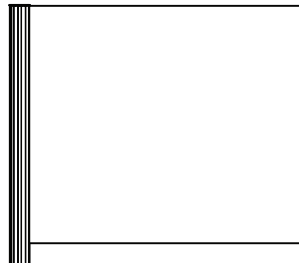

B

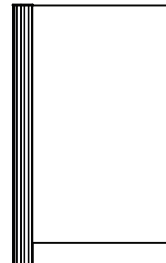

C



D

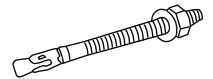

E



F

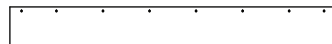

G

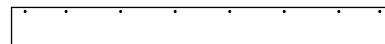

H



I

We recommend that a risk assessment is undertaken to identify an appropriate location for your waste collection and recycling units. In order to reduce risk, some organisations decide to place the units a **minimum of 5 metres** away from buildings. Any potential risk can be further reduced by maintaining a regime of regularly emptying the unit.



Glasdon AND MODUS™ ARE TRADEMARKS OF GLASDON GROUP AND ITS SUBSIDIARIES IN THE U.K. AND OTHER COUNTRIES.

Replacement components are available direct from GLASDON. Glasdon U.K. Ltd reserves the right to alter specifications without prior notice. GLASDON cannot be held responsible for claims arising from incorrect installation, unauthorised modifications or misuse of the product.

Issue 2 December 2011
© Copyright 2011

C000/0406



Glasdon

Preston New Road
BLACKPOOL
Lancashire FY4 4UL
Tel: 01253 600410
Fax: 01253 792558
E-mail: sales@glasdon-uk.co.uk
Web: www.glasdon.com

Step 1: Assembly of Three Sided Screen

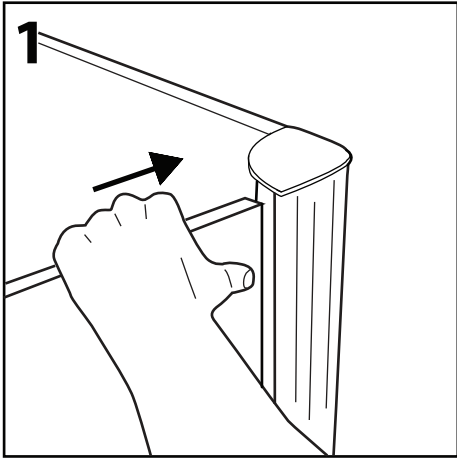

Hold panel (B) up to the left hand extrusion on panel (A) ensuring that the feet with the pre-drilled holes are on the ground. Push the end of the board into the extrusion slot.

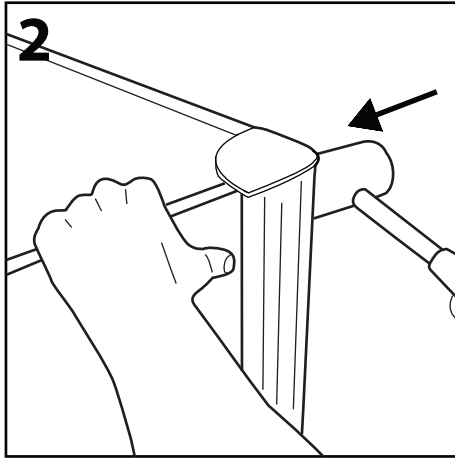

Using rubber mallet (so not to damage the extrusions) tap the side at the top of the extrusion so that the board is pushed firmly into the extrusion without any gaps.

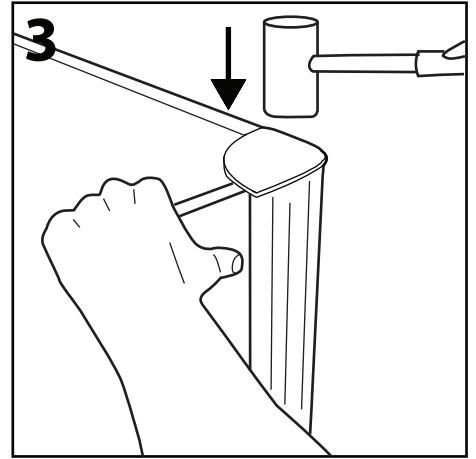

Tap the top of the extrusion to ensure the board is level up to the top of the extrusion cover cap.

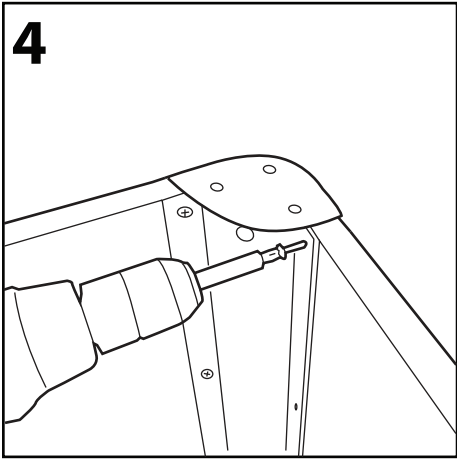

Using hand drill and screw provided (D), secure the top fixing in position by screwing from the inside of the extrusion into the board.

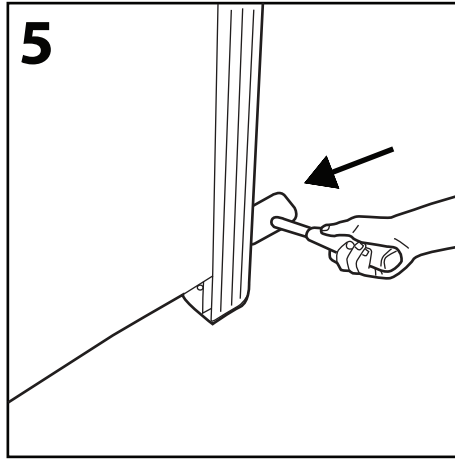

Using rubber mallet, tap the side at the bottom of the extrusion to ensure that the board is pushed firmly into the extrusion without any gaps.

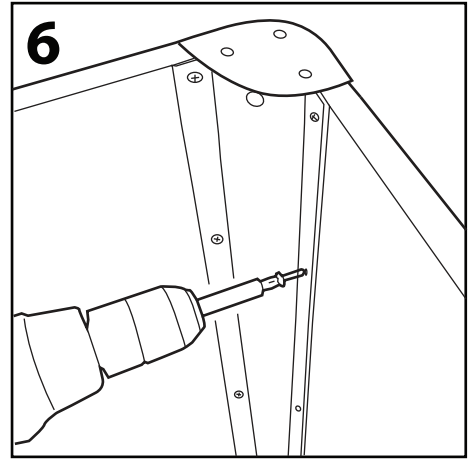

Using hand drill and 6 off screws provided (D), secure the remaining fixings on the inside of the extrusion by screwing through the extrusion into the board.

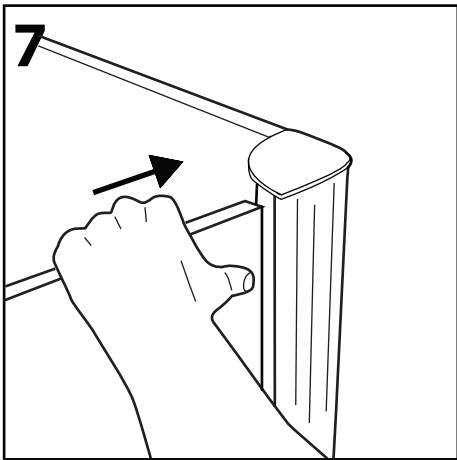

With two panels assembled offer panel (C) up to the left hand extrusion on panel (B) ensuring that the feet with the pre-drilled holes are on the ground. Push the end of the board into the extrusion slot.

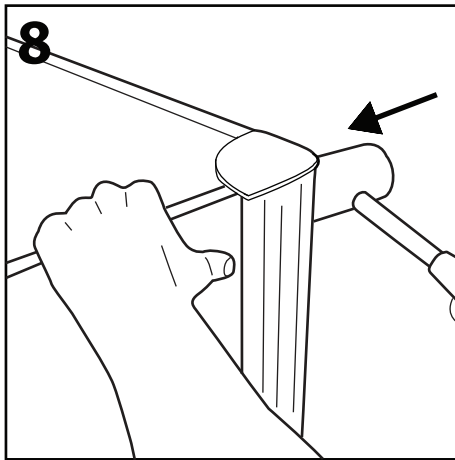

Using rubber mallet, tap the side at the top of the extrusion so that the board is pushed firmly into the extrusion without any gaps.

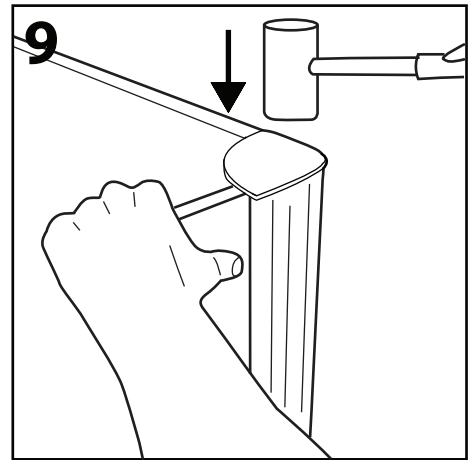

Tap the top of the extrusion to ensure the board is level up to the top of the extrusion cover cap.

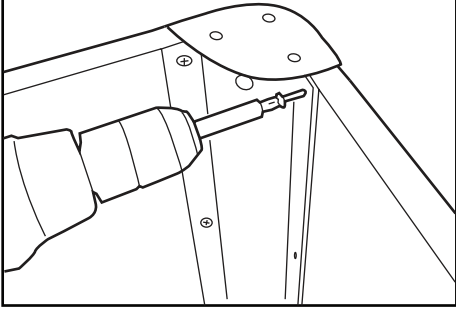
10

Using hand drill and screw provided (D), secure the top fixing in position by screwing from the inside of the extrusion into the board.

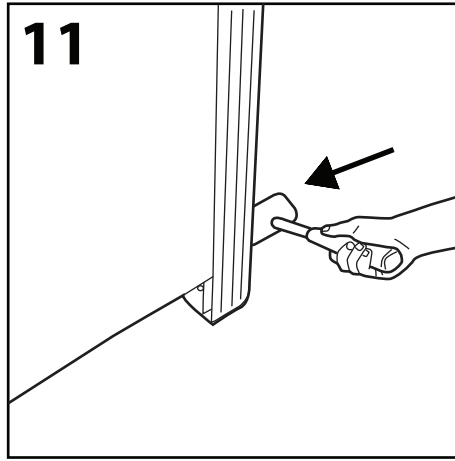
11

Using rubber mallet, tap the side at the bottom of the extrusion to ensure that the board is pushed firmly into the extrusion without any gaps.

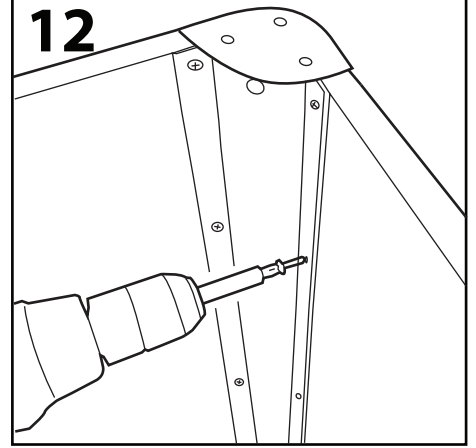
12

Using hand drill and 6 off screws provided (D), secure the remaining fixings on the inside of the extrusion by screwing through the extrusion into the board.

Step 2: Adjustment of Spigot Legs When Sited on Uneven Ground

(If not required move on to Step 3)

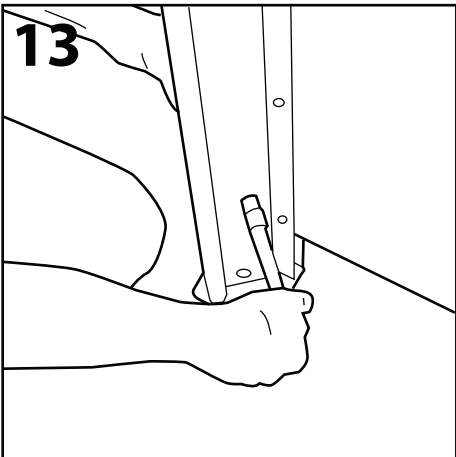
13

Using a 13mm spanner/socket unscrew the two bolts with washers on the inside at the bottom of the extrusions and remove.

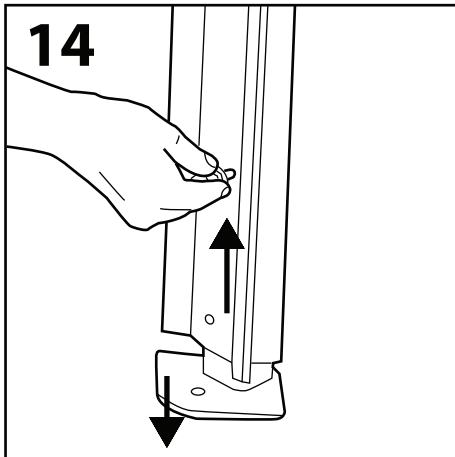
14

Lift the extrusion upwards and pull the spigot leg down to a more appropriate height ensuring that the screen is now level.

15

Replace the bolts and washers into the new holes within the spigot leg and tighten with spanner/socket. Repeat Figs 13-15 on the other legs that need adjusting.

Step 3: Ground Fixing (Concrete In)

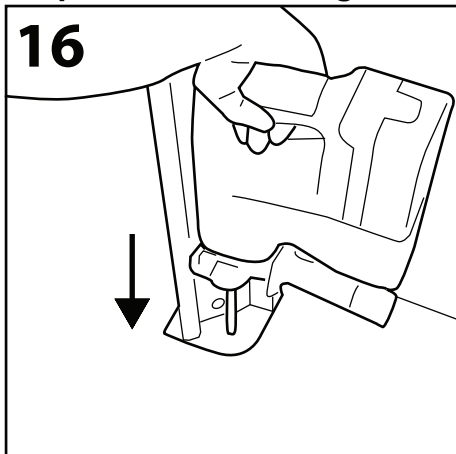
16

Using a 10mm masonry drill bit, drill through the hole in the spigot leg down into the concrete approximately 150mm deep.

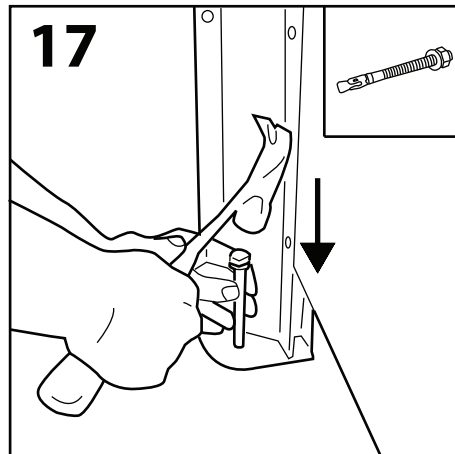
17

The fixing bolts (E) MUST appear as above with the nut and washer at the top of the bolt. Using a hammer, tap fixing bolt through the hole in the spigot leg until it is flush with the spigot plate.

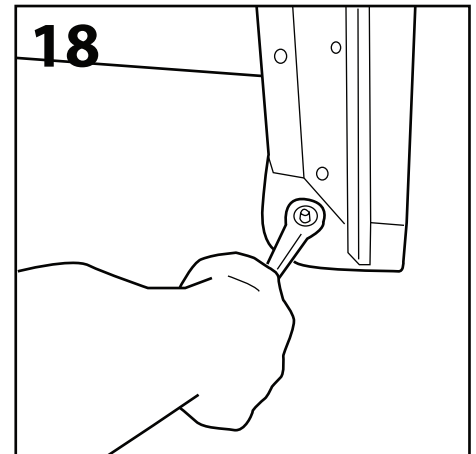
18

Tighten bolt using 17mm spanner. Repeat Figs 16-18 to ground fix the other three extrusions.

Step 4: Attaching and Ground Fixing Compulsory Support Legs

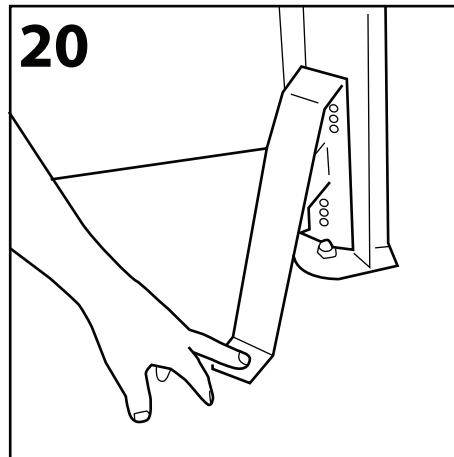
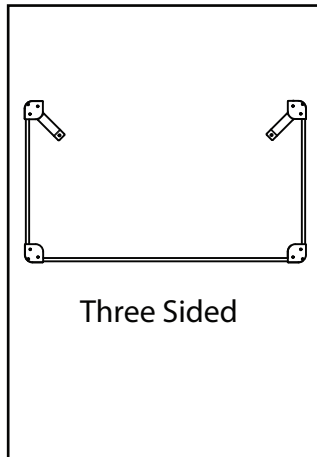
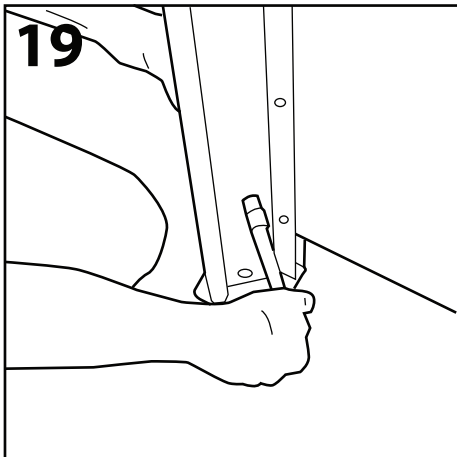

Using a 13mm spanner/socket unscrew the two bolts with washers at the bottom of the outermost extrusions and remove. (see diagram above showing location of support legs) If the spigot legs have been adjusted (Step 2) the panels will need to remain lifted in position so that the support legs go into the correct holes (may require two people).

Place the support leg (F) up against the inside of the extrusion so that the leg protrudes outwards and stands on the ground. If the spigot legs have been adjusted there are several pre-drilled holes in the support leg to accommodate this adjustment.

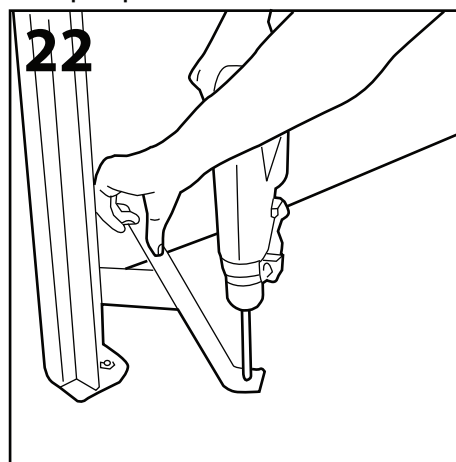
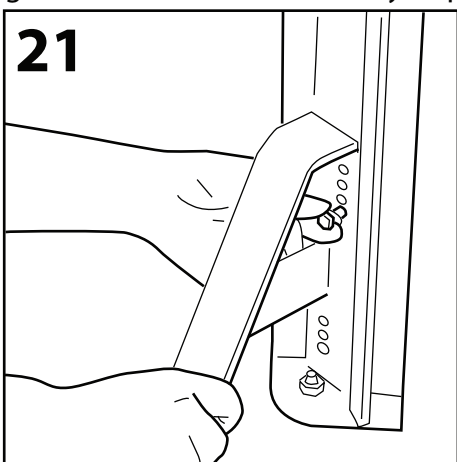

Replace the bolts and washers into the new holes through the support leg, extrusion and into the spigot leg. Tighten with 13mm spanner/socket.

Ground fix the support legs into the ground as per Figs 16 - 18 (Step 3).

Step 5: Attaching Rubber Skirting (Optional)

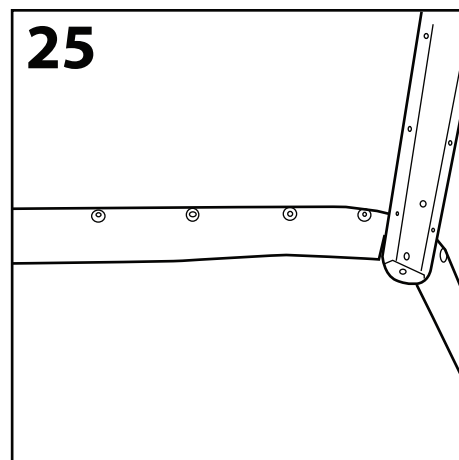
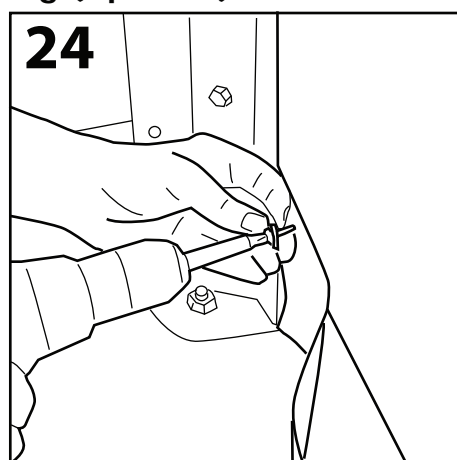
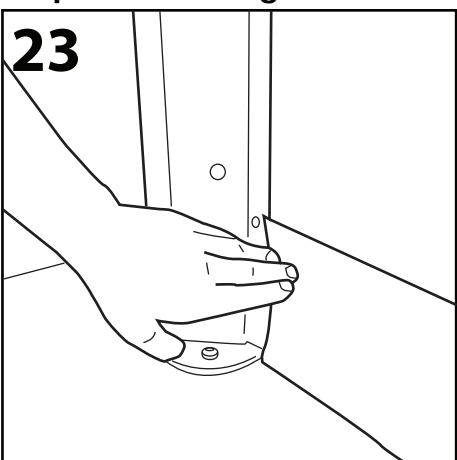

Using side skirting (G), on the INSIDE of the screen, align the end of rubber next to the extrusion so that it is touching the ground.

Using a screw (D) and washer (I), screw the fixing through the pre-drilled hole in the skirting into the board.

Repeat Fig 24 using the other fixings along the skirting ensuring to pull the rubber tight inbetween each point. Repeat Figs 23 - 25 using second side skirting (G) and front skirting (H).