

# Echelon™ Cycle Shelter

## GROUND FIXING & END PANEL INSTALLATION INSTRUCTIONS

**IMPORTANT NOTE: ENSURE THAT ALL RELEVANT PERSONNEL READ THESE INSTRUCTIONS PRIOR TO USE**

Please also refer to the 'Manual Handling Operations Regulations 1992' during the handling of the product and materials used for installation. Glasdon recommends that a full Health and Safety analysis is carried out prior to installation.

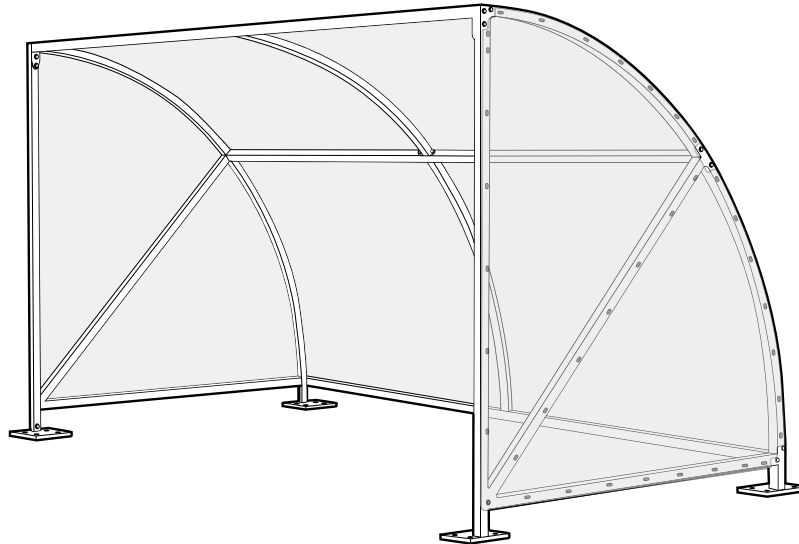

### GROUND FIXING KIT CONTENTS

- ITEM 1 - Self Tapping Anchor Bolt (M10 x 100mm) x12
- ITEM 2 - Washer (M12 x 23mm) x12

### OPTIONAL END PANEL FIXING KIT CONTENTS:

	1 Panel Kit	2 Panel Kit
ITEM 3 - 3mm Polycarbonate End Panel	x 1	x 2
ITEM 4 - Self-Drilling Screw (M6 x 40mm)	x 39	x 78
ITEM 5 - Penny Washer M6	x 39	x 78
ITEM 6 - Spacer (M6 x 10 x 3mm)	x 39	x 78
ITEM 7 - Rubber Washer	x 39	x 78

### TOOLS/EQUIPMENT REQUIRED:

- 4mm Allen Key (supplied)
- Drill (Battery operated)
- Drill to Socket Adapter (optional)
- 8mm Socket
- High Impact Drill
- 10mm Masonry Drill Bit
- 17mm Socket
- Socket Wrench or Torque Wrench
- Spiral Brush or Air Blower (optional)

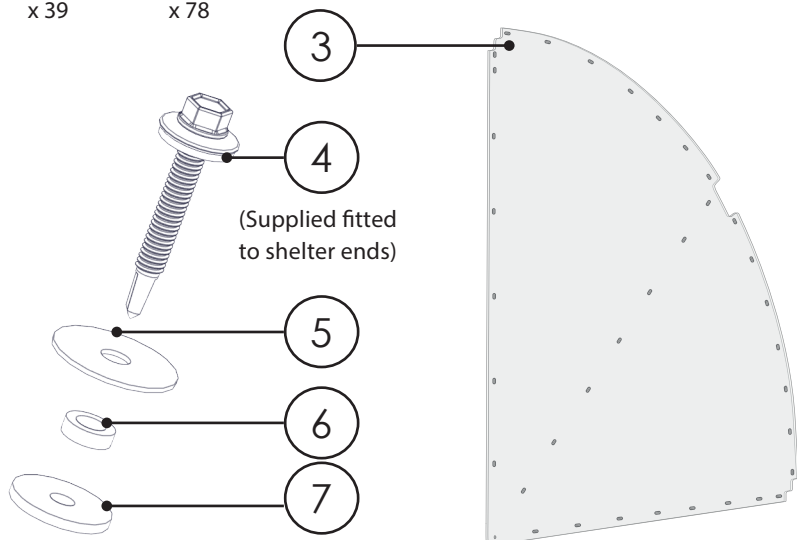
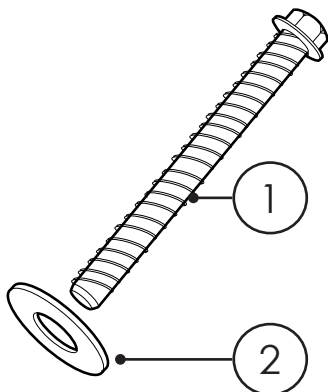
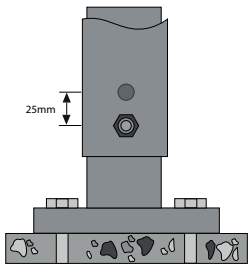
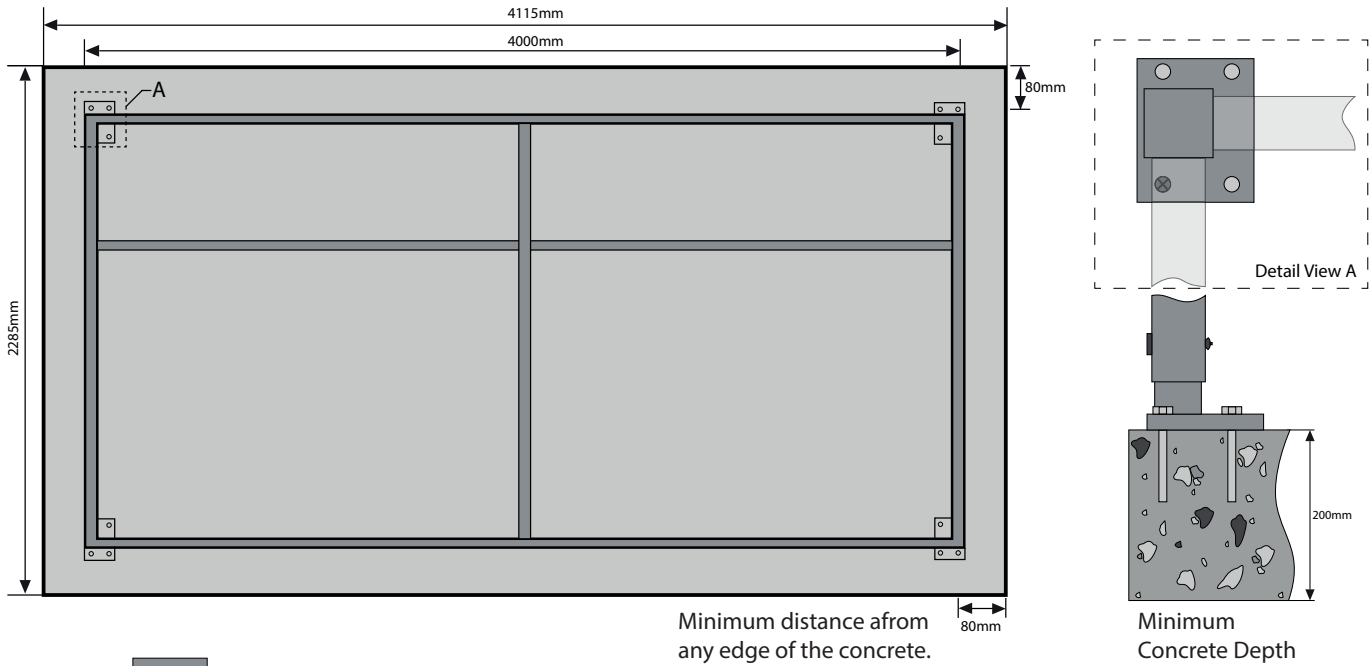

DIAGRAM NOT TO SCALE

# INSTALLATION - GROUND FIXING INSTRUCTIONS

## Concrete Surface Mount



### Adjustable Feet

In cases of uneven ground, use the adjustable feet to level the shelter. Using the socket wrench, untighten the fixing.

Use a pump truck or alternative lifting equipment to raise the shelter to the desired level. Place the fixing through the chosen hole and re-tighten using the socket wrench.

Once you are happy with the final location, overtighten the fixing using a socket wrench to break off the shear nut head for improved security.

*For optimum fixing performance the following procedure is recommended.*

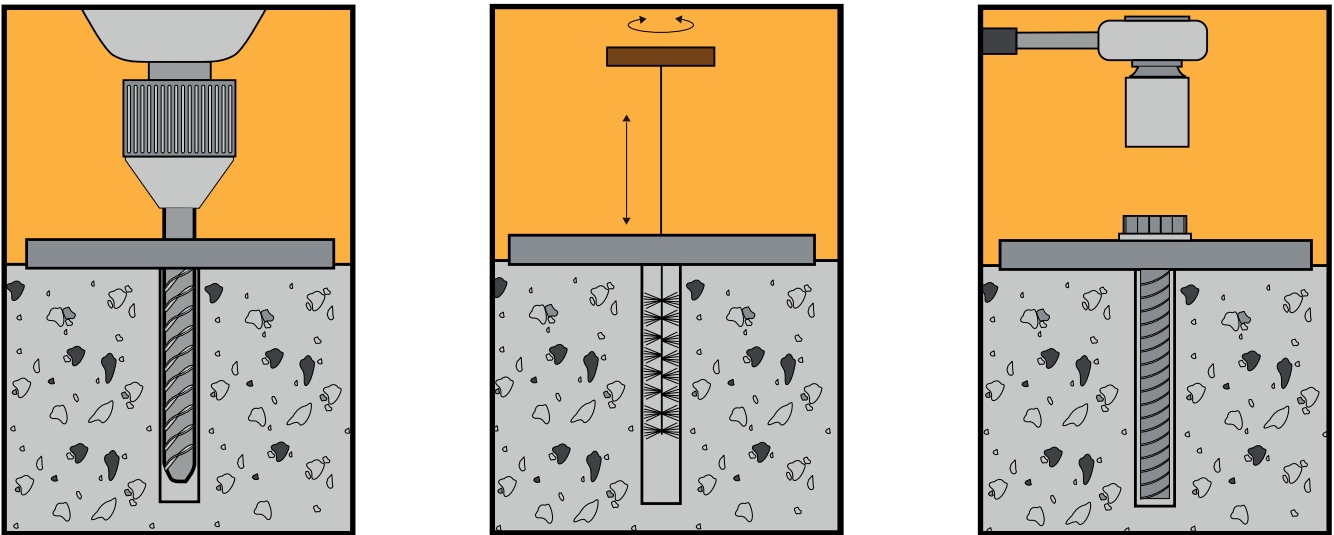

The base should be flat, steel float finished, level and square and preferably be raised slightly above the surrounding ground level.

The concrete base should be a minimum 25N/20mm mix strength equivalent of BS. 5328, Section 2, Part 10, Grade C25.

Using the supplied unit as a template, drill through 3 of the 4 (**See Detail View A**) base fixing positions in each of the feet with a 10mm masonry drill to a minimum depth of 120mm.

Clean drill hole thoroughly using a spiral brush and remove all dust using a blow out pump, air line or similar.

Insert the ground fixing and washer into the drilled hole and tighten with socket and wrench.

## ASSEMBLY

### Optional Polycarbonate End Panels

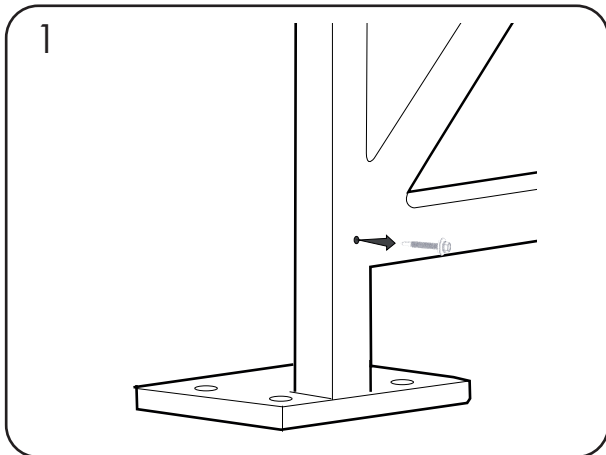

Remove all of the fixing screws (Item 4) from the end of the shelter using the 8mm socket and socket wrench (or use the drill and drill adaptor for speed).

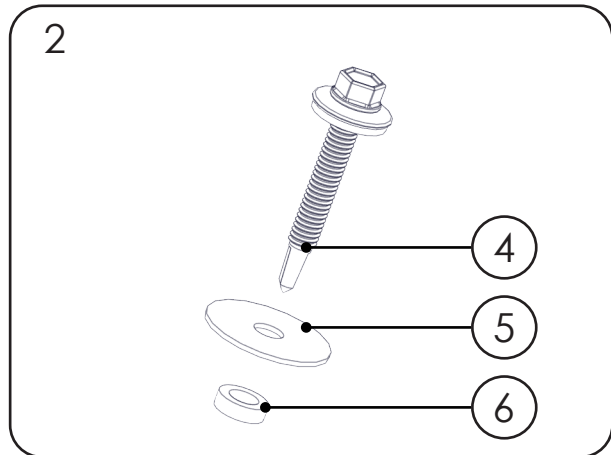

Assemble the fixings needed for the end panels by placing Items 5 and 6 over Item 4.

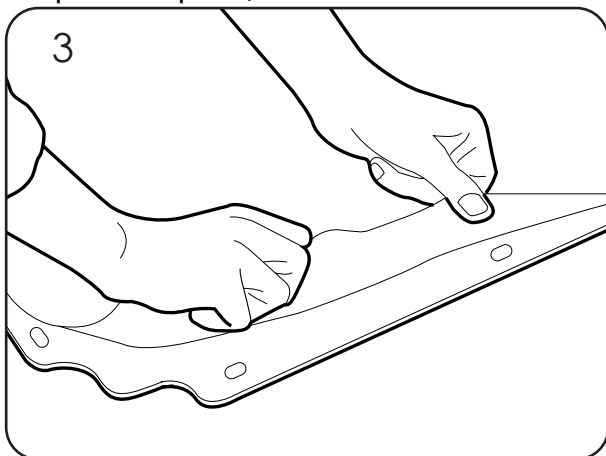

On the outside of the panel, peel back the protective film around the perimeter of the polycarbonate panel (Item 3) to reveal the fixing holes. On the inside of the panel remove the protective film entirely.



Lift the panel up against the frame and align the holes with the fixing points in the frame.

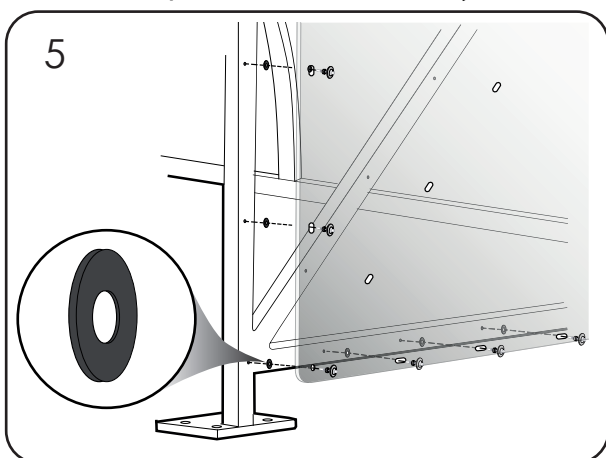

Beginning in the lower front corner of the frame, place the assembled fixing through the hole in the panel (Item 3). Place a rubber washer (Item 7) between the panel and the frame and tighten fixing half way using socket.

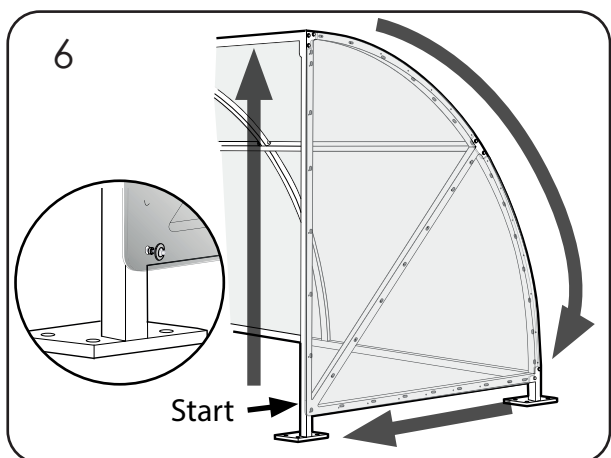

Repeat for all fixings on the perimeter of the panel ONLY. Tighten each half way at this stage to allow fixings to be fitted to diagonal beam.

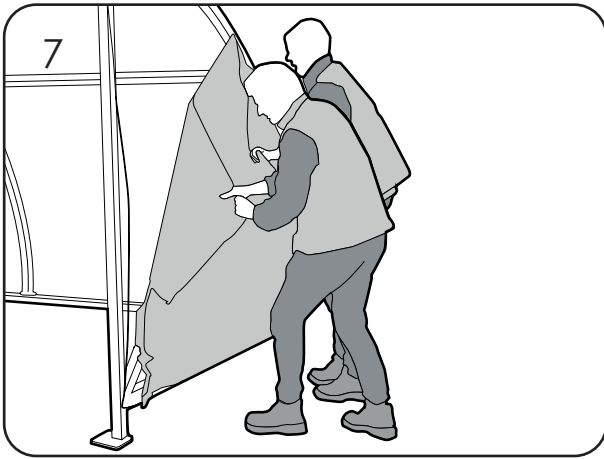

Remove the remaining protective film from the panel.

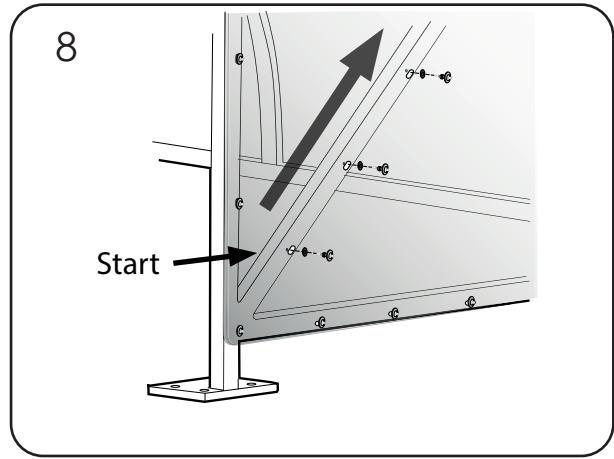

Attach fixings on diagonal beam starting from the lower corner (see STEP 9 for method).

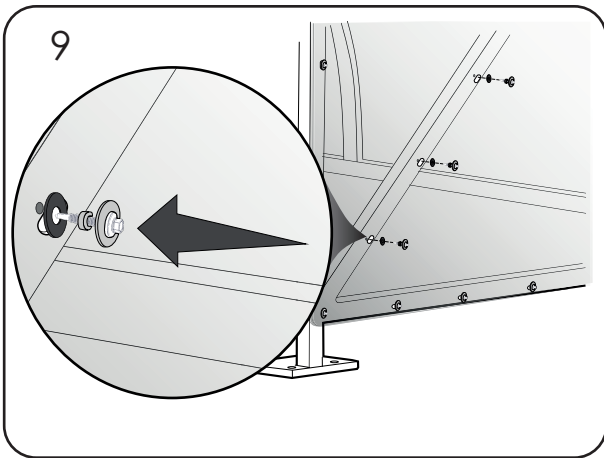

Place the rubber washer (Item 7) onto the thread of the assembled fixing (Item 4) and push the washer through the slot in the polycarbonate panel so that it sits between it and the frame. Then proceed to tighten the fixing.

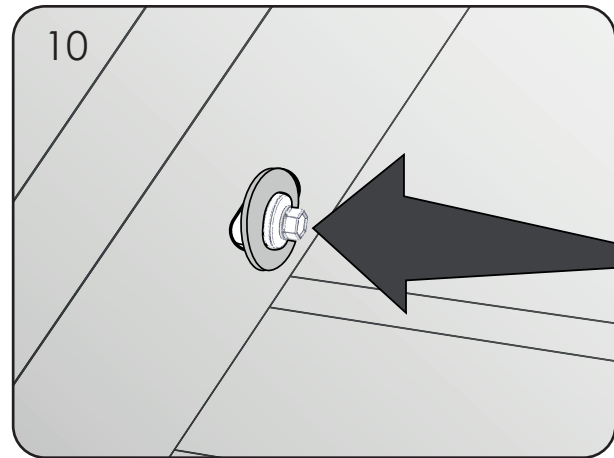

Tighten all remaining fixings fully to secure the side panel in place.

**\*NOTE: Take care, do not overtighten as this may crack or damage the polycarbonate. If using a torque wrench or drill to tighten - a force of no more than 10Nm is required.**

IMPORTANT NOTE: PLEASE ENSURE THAT ALL RELEVANT PERSONNEL READ THE POINTS LISTED WITHIN THIS LEAFLET AND THAT A COPY IS GIVEN TO STAFF INVOLVED WITH THE INSTALLATION AND MAINTENANCE OF THIS PRODUCT.

SAFETY NOTE: PLEASE REFER TO 'THE MANUAL HANDLING OPERATIONS REGULATIONS 1992' DURING HANDLING.

 **Glasdon** AND GLASDON ECHELON ARE TRADEMARKS OR REGISTERED TRADEMARKS OF GLASDON GROUP OR ITS SUBSIDIARIES IN THE U.K. AND OTHER COUNTRIES.

- A planned maintenance schedule or regular inspection is recommended, replacing components as necessary.
  - Replacement components are available direct from GLASDON.
  - GLASDON cannot be held responsible for claims arising from incorrect installation, unauthorised modifications or misuse of the product.
- Stock No. C000/1034 - DWG No. 12B-112-13 Issue 4 - October 2021  
 © Copyright 06/2018  
 Glasdon UK Ltd reserve the right to alter specifications without prior notice.

 **Glasdon®**  
**Glasdon U.K. Limited**  
 Preston New Road  
 BLACKPOOL  
 Lancashire  
 FY4 4UL  
 Tel: (01253) 600410  
 Fax: (01253) 792558  
 e-mail: sales@glasdon-uk.co.uk  
 web: www.glasdon.com